

METAL ARMoured

FEATURES

- Nickel plated brass cable glands for steel wire armoured cables with unique wedge seal for quick and easy installation
- Weatherproof IP66 rated with seal to cable outer jacket
- Large cable range per gland reduces inventory range
- Conforms to BS6121: Part 1: 1989
- Locknuts sold separately

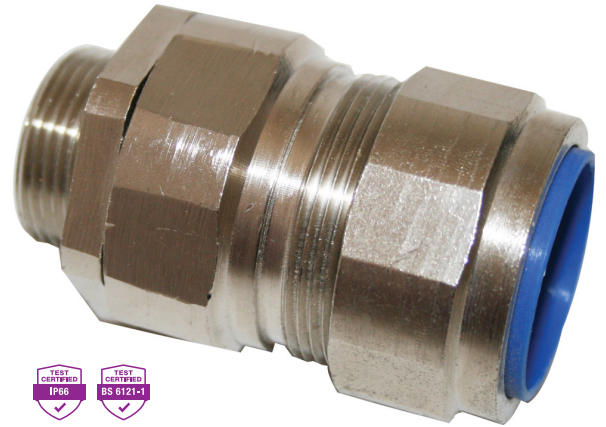
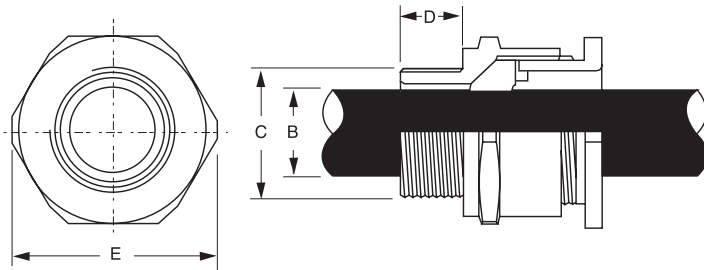

ORDERING INFORMATION

PART NO.	C MOUNTING THREAD DIA. (MM)	D THREAD LENGTH (MM)	A MAX. UNDER ARMOUR CABLE RANGE (MM)	B MIN. CABLE RANGE (MM)	B MAX. CABLE RANGE (MM)	ARMOUR WIRE DIA. (MM)	ACROSS CORNERS (MM)	SHROUD	UNIT	QTY
CW20/16	20	15	8.6	8	13.4	0.9	24.5	1	EA	1
CW20S	20	15	11.6	11.4	15.9	0.9 - 1.25	26.5	1	EA	1
CW20	20	15	13.9	15	20.9	0.9 - 1.25	30	2	EA	1
CW25	25	15	19.9	20.3	27.4	1.25 - 1.6	39.9	3	EA	1
CW32	32	15	26.2	26	33.9	1.6 - 2.0	46	4	EA	1
CW40	40	15	32.1	31	40.4	1.6 - 2.0	55.3	5	EA	1
CW50S	50	15	38.1	36.5	46.7	2.0 - 2.5	61.3	6	EA	1
CW50	50	15	44	43	53.1	2.0 - 2.5	66.8	7	EA	1
CW63S	63	15	50	48.9	59.4	2.5	77.5	7	EA	1
CW63	63	15	55.9	58	65.9	2.5	83.2	7	EA	1

In support of our policy of continuous product improvement we reserve the right to change materials and specifications without notice. Drawings, where used, are not to scale. All dimensions are in millimetres and sizes given are approximate. Where possible, technical MSDS data sheets are made available on the website. All products should be installed and used in accordance with manufacturer's instructions provided. Warning: products may be the subject of registered designs and patents. Refer to website for terms and conditions on warranty.

METAL GLANDS - ARMoured CABLES 1P66 - GLAND SELECTION CHART FOR 0.6/1KV ARMoured PVC CABLES WITH CIRCULAR COPPER CONDUCTORS

CABLE	2 CORE & EARTH	3 CORE & EARTH	3 ^{1/2} CORE & EARTH	4 CORE & EARTH
1.5	CW20S	CW20		CW20
2.5	CW20	CW20		CW20
4	CW20	CW20		CW20
6	CW20	CW25		CW25
10	CW25	CW25		CW25
16	CW25	CW25		CW32
25	CW32	CW32		CW32
35		CW32		CW40
50		CW40	CW50S	CW50S
70		CW50S	CW50S	CW50
95		CW50S	CW50	CW63S
120		CW50	CW63S	CW63S
150		CW63S	CW63S	CW63
185		CW63S	CW63	

Technical Data

Material

Body Brass
 Seal Neoprene rubber
 Finish Nickel plated

Conformant Standard

BS6121

IP Rating

IP66

Note: This chart should be used as a guide only. Cable dimensions vary by manufacturer and insulation type.

In support of our policy of continuous product improvement we reserve the right to change materials and specifications without notice. Drawings, where used, are not to scale. All dimensions are in millimetres and sizes given are approximate. Where possible, technical MSDS data sheets are made available on the website. All products should be installed and used in accordance with manufacturer's instructions provided. Warning: products may be the subject of registered designs and patents. Refer to website for terms and conditions on warranty.